

FOR INQUIRY

CALL: 75750 07337

Visit: shivalikgroup.com/satyamev

RERA Reg No. : PR /GJ/ AHMEDABAD/ AHMADABAD CITY/ AUDA/ CAA00312/ 031017

SHIVALIK[®]
BUILDING LANDMARKS

SHIVALIK PROJECTS

Beside Satellite Police Station, Satellite
Ahmedabad 380 015, INDIA
Call: +91 79 4020 0000
www.shivalikprojects.com



 **SATYAMEV**

SATYAMEV DEVELOPERS

Satyamev Complex, Opp. High Court
S.G. Highway, Ahmedabad, INDIA
Call: +91 79 2766 2710 / 2115
www.satyamevdevelopers.co.in

MEMOR +91 79 4002 4000

SHIVALIK
SATYAMEV





LAYOUT PLAN



GROUND FLOOR

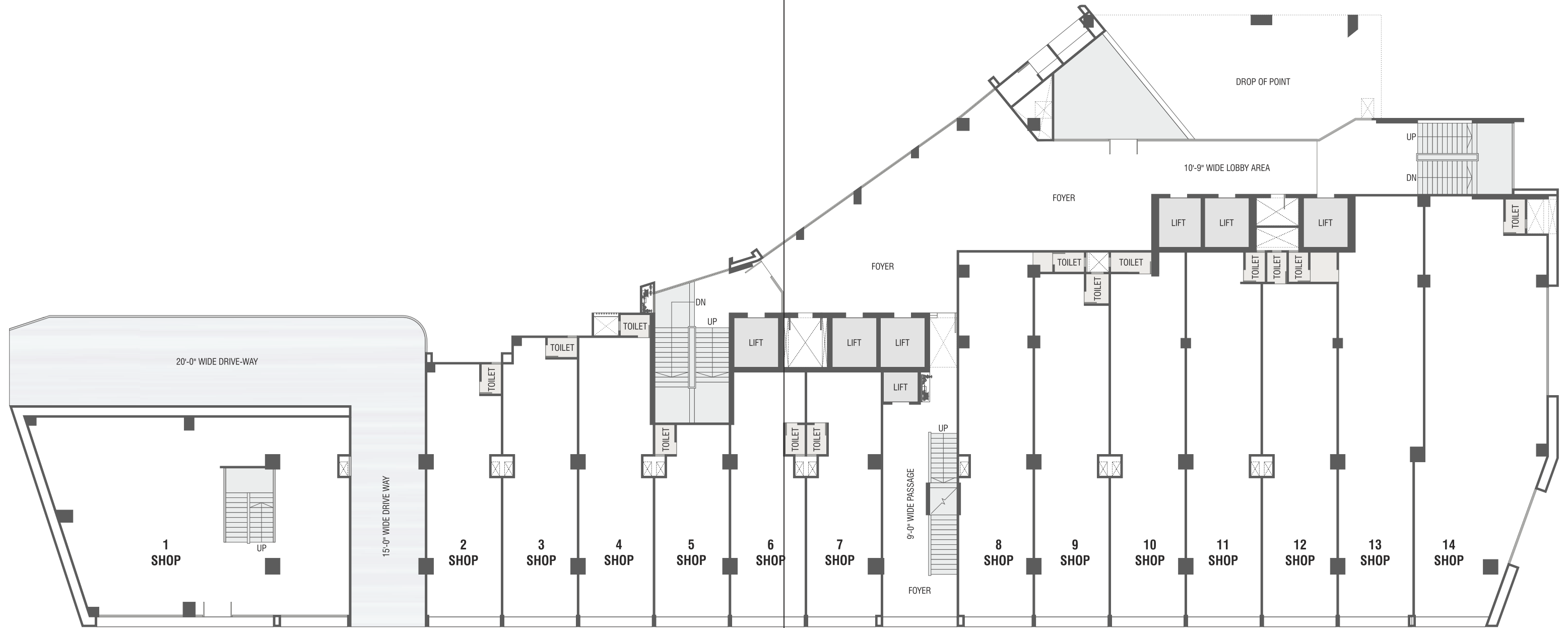

1st FLOOR

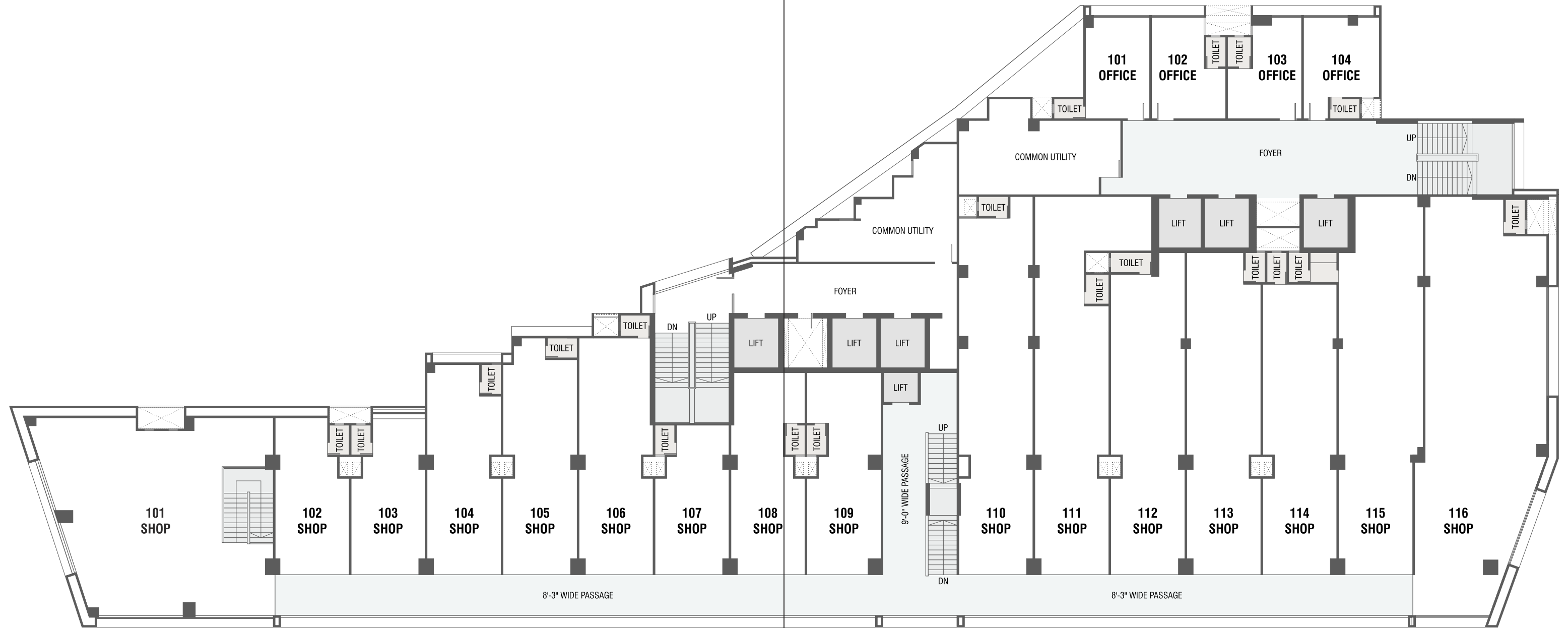

2nd FLOOR

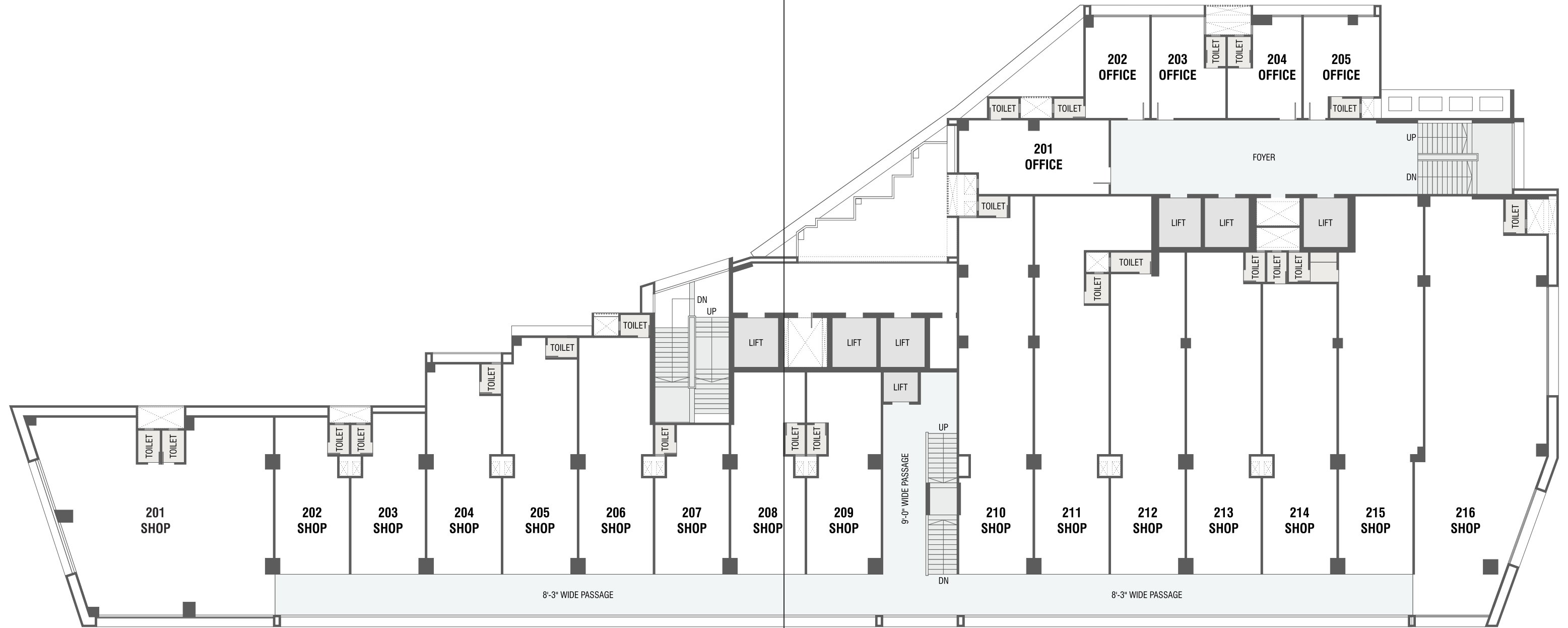

3rd | 4th | 7th
10th FLOOR

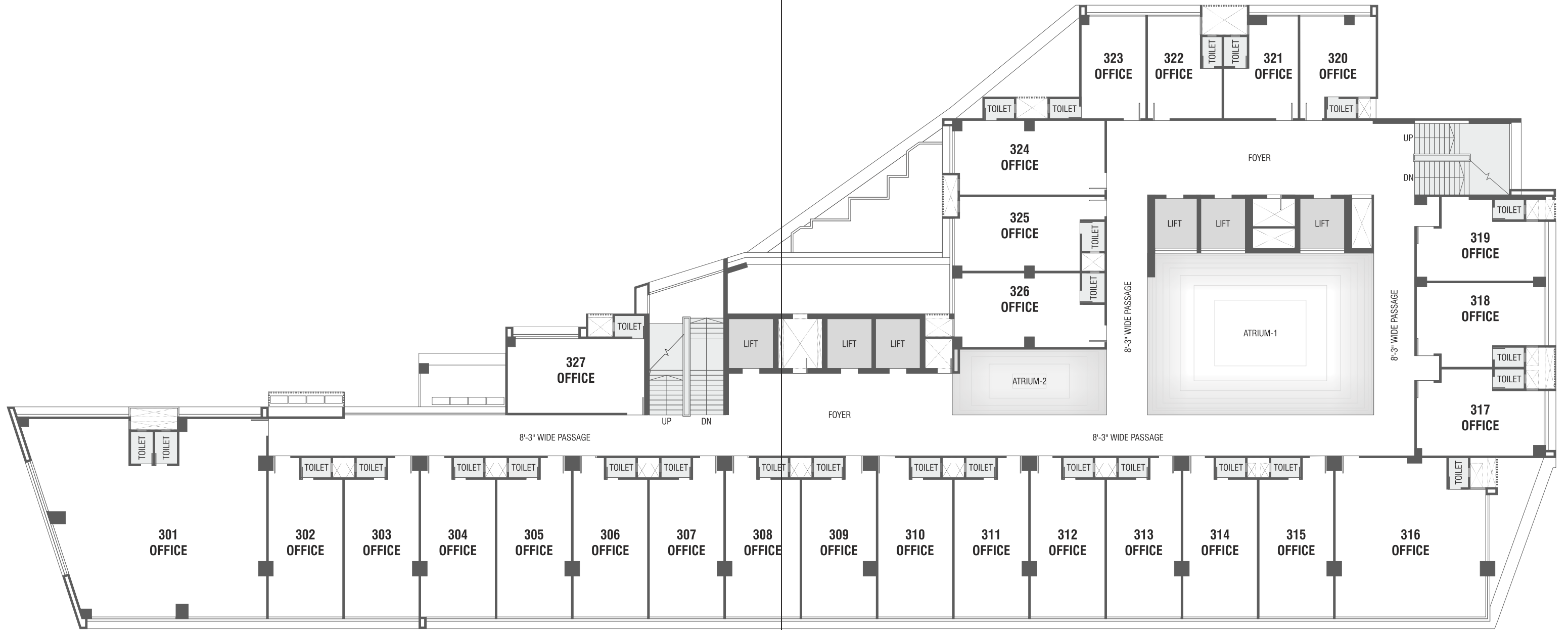

5th | 11th FLOOR

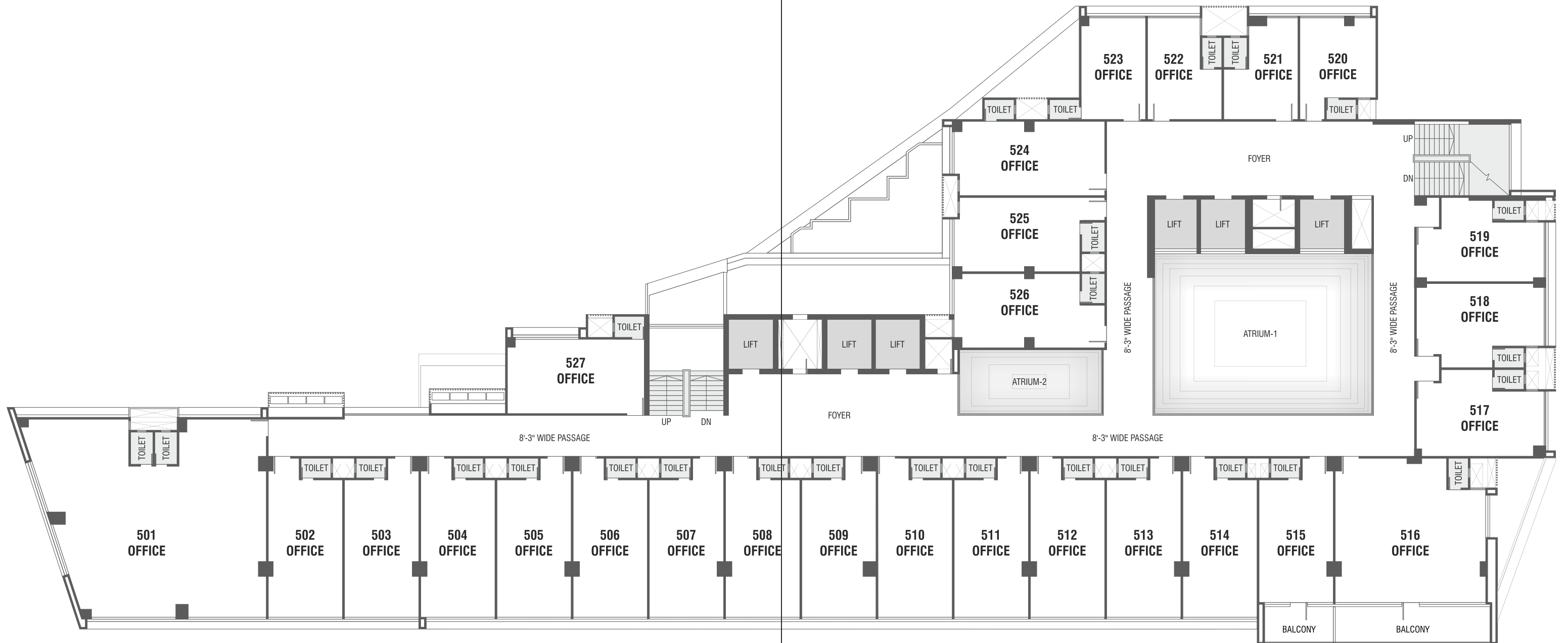

6th | 12th FLOOR

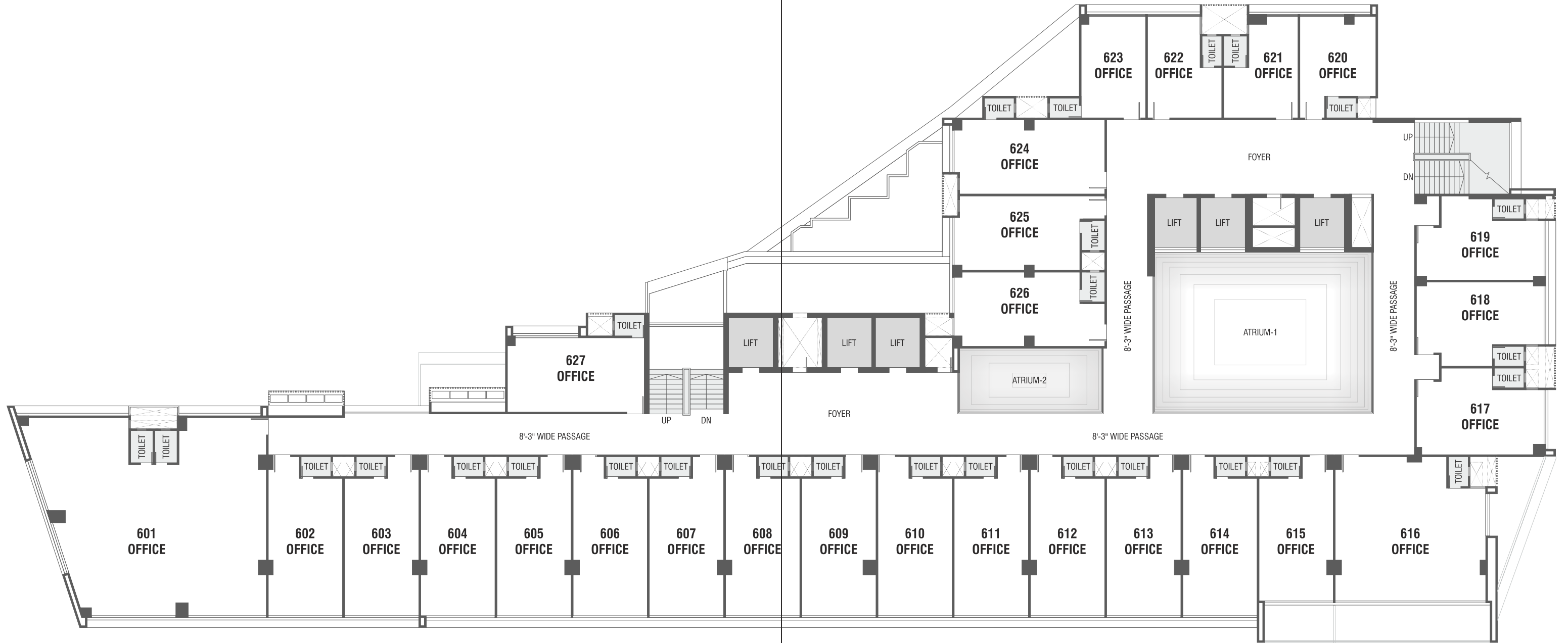

8th FLOOR

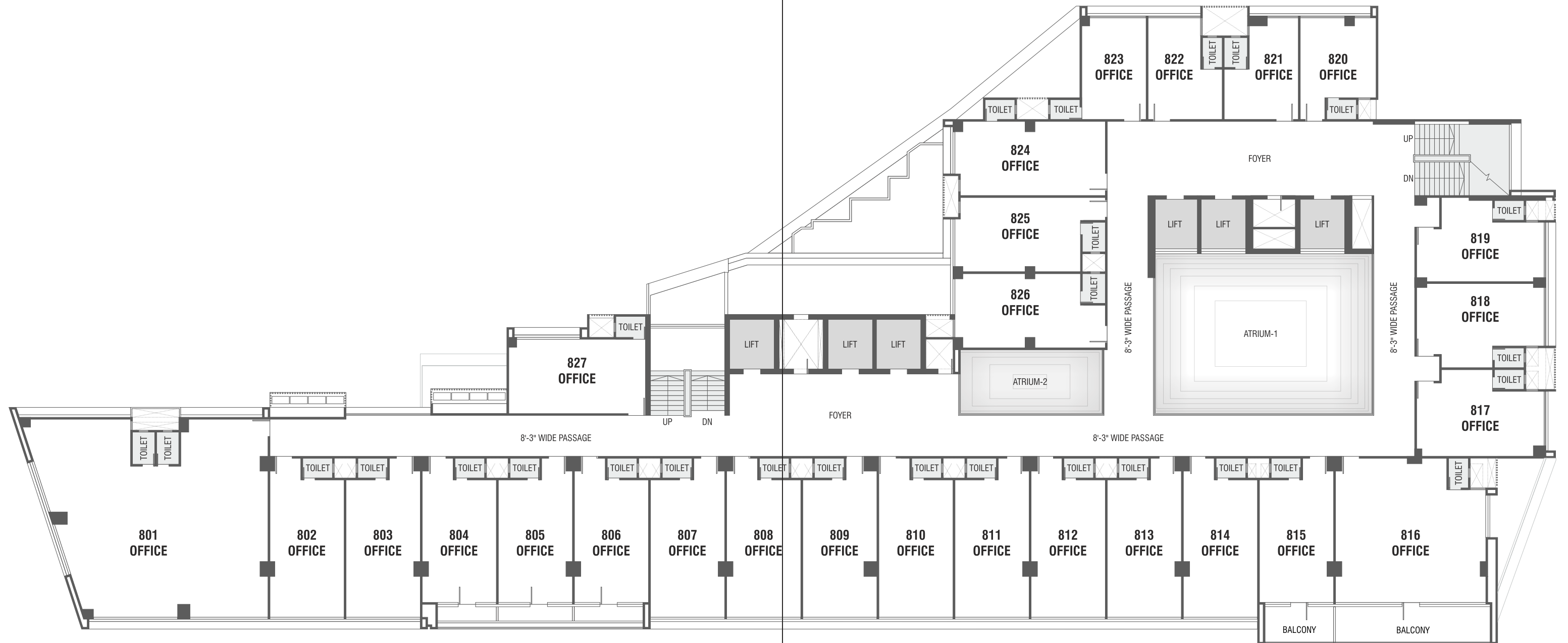

9th FLOOR

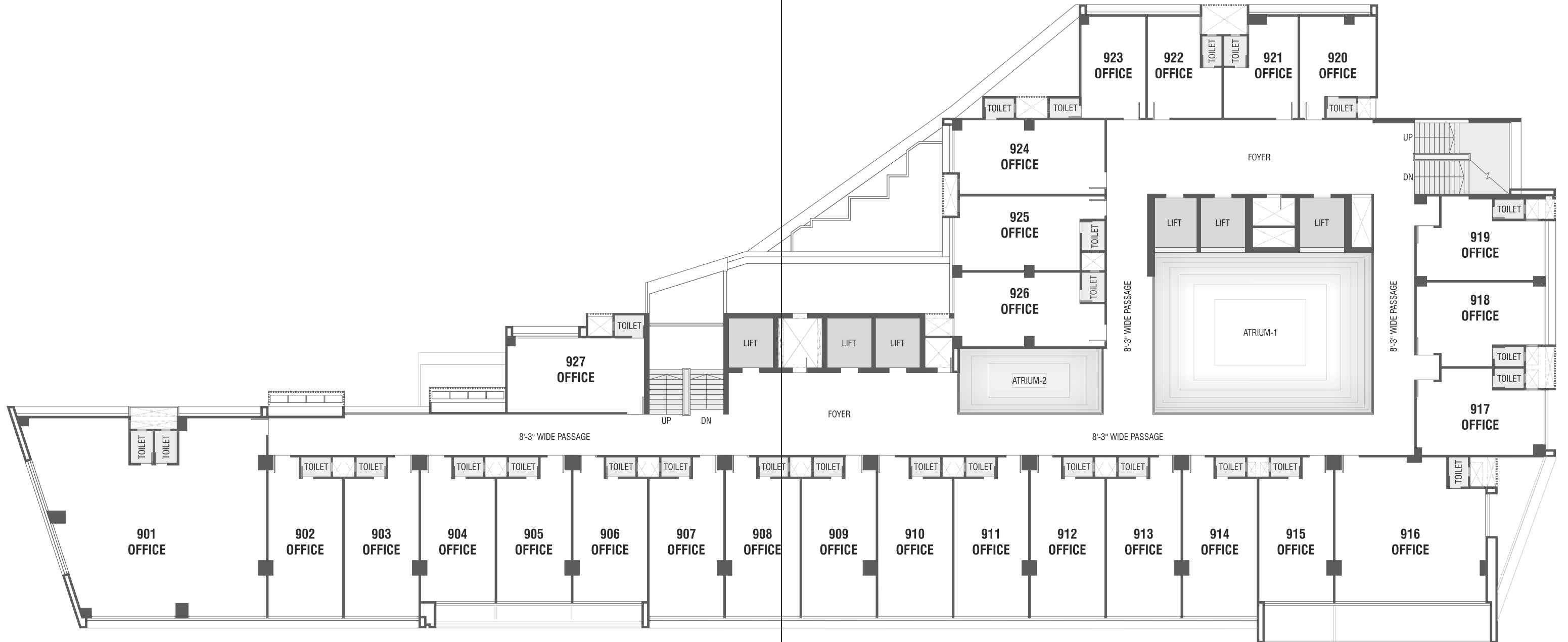

13th FLOOR

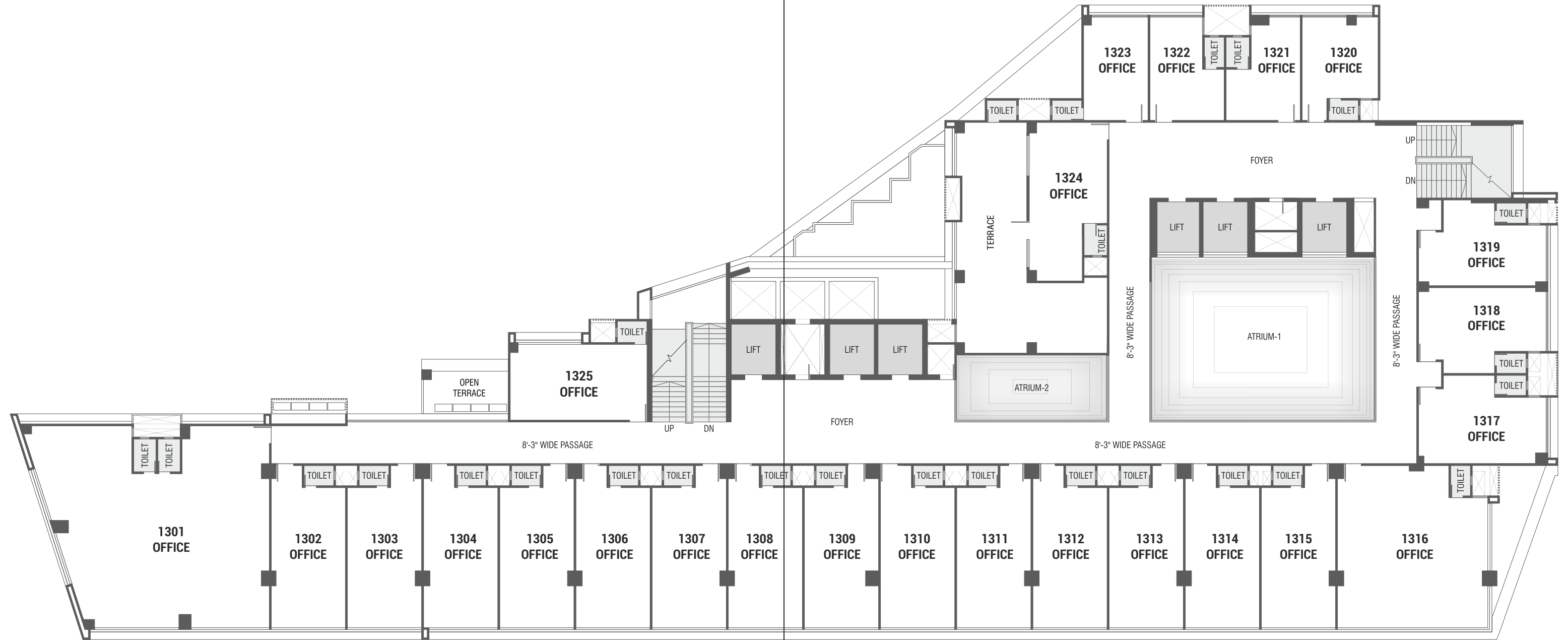





REFERENCE IMAGE

ATRIUM 1



REFERENCE IMAGE

ATRIUM 2



REFERENCE IMAGE

ENTRANCE



REFERENCE IMAGE

ENTRANCE

AMENITIES

SHOWROOMS / OFFICES

MULTI LEVEL PARKING

ALLURING ATRIUM

ENTICING LOBBY

GENERAL SPECIFICATIONS

TILES FLOORING STANDARD VITRIFIED

ELECTRIFICATION ADEQUATE ELECTRIC POINTS INCLUDING TELEPHONE POINTS

SALIENT FEATURES

- ELEGANT APPEARANCE OF THE BUILDING
- WELL - PAVED MARGIN AREA
- AUTOMATED ELEVATORS OF INTERNATIONAL COMPANY
- 24 HOURS WATER SUPPLY

LOCATION



TERMS:

Rights reserved by the developers to make any changes in plan, elevations and other details which will be binding to all the members • In order to maintain the aesthetics of the building at a very high level, installation of AC units will be permitted at the designated spots and nowhere else, changes which affect the elevation and structure system shall not be permitted for all times to come • Encroachment. in any form, outside the defined units shall not be allowed • Merchandise, articles, etc. cannot be stored / kept in common areas as defined by the project managers • Only internal changes shall be made with prior permission and shall be charged extra in advance • All dimensions shown in the plans are approximate, average, unfinished and subject to variations • Service tax and any other taxes will be extra • Change in services of individual units will not be permissible • **Any external signages for offices shall not be permitted for all times to come** • Payments are to be made in favour of "ShivalikSatyamev"

RERA Registration No. - PR/GJ/AHMEDABAD/AHMEDABAD CITY/AUDA/CAA00312/031017